

DET. D12  
ESC: 1/10

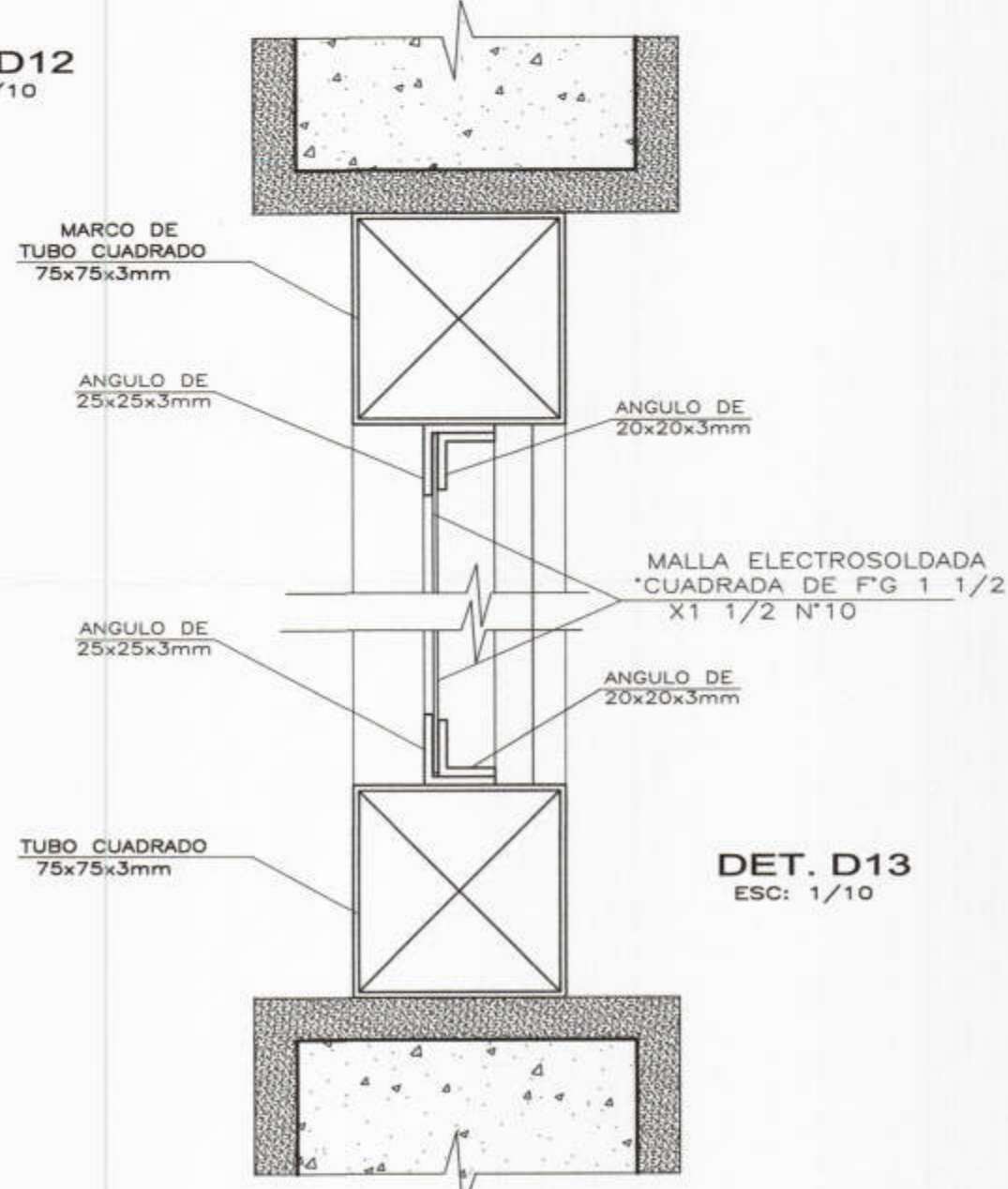

DET. D13  
ESC: 1/10

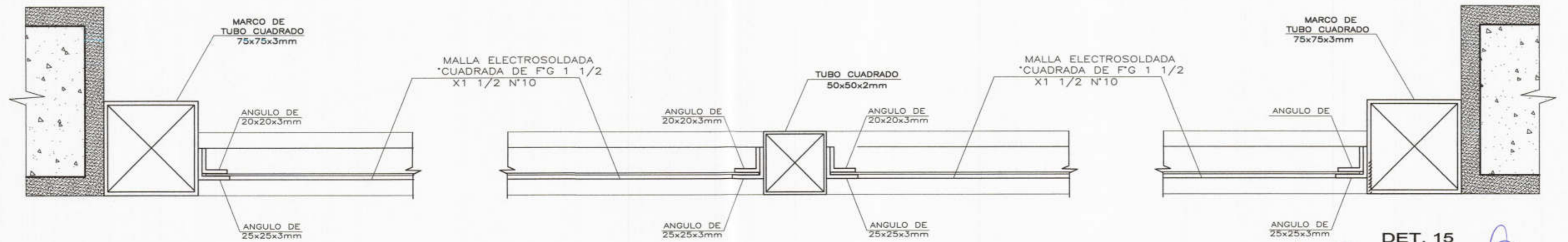
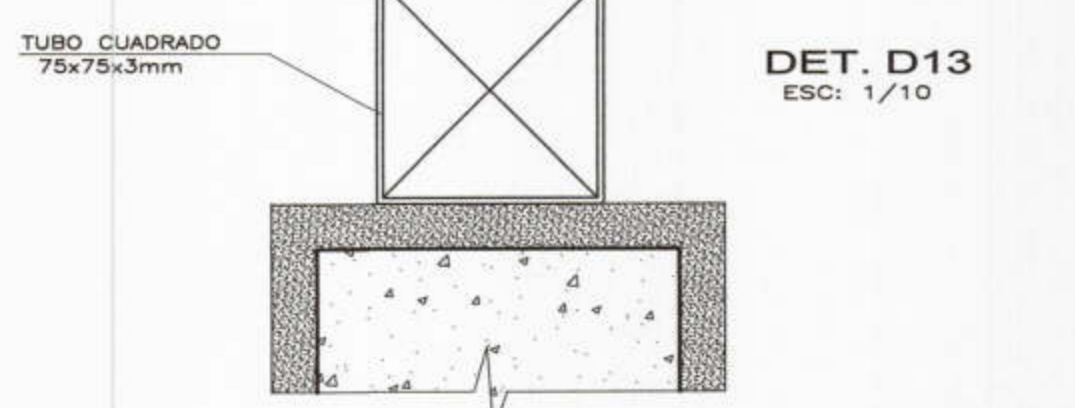

DET. 14  
ESC: 1/10

DET. 15  
ESC: 1/10

Detalle 05  
ESC: 1/10

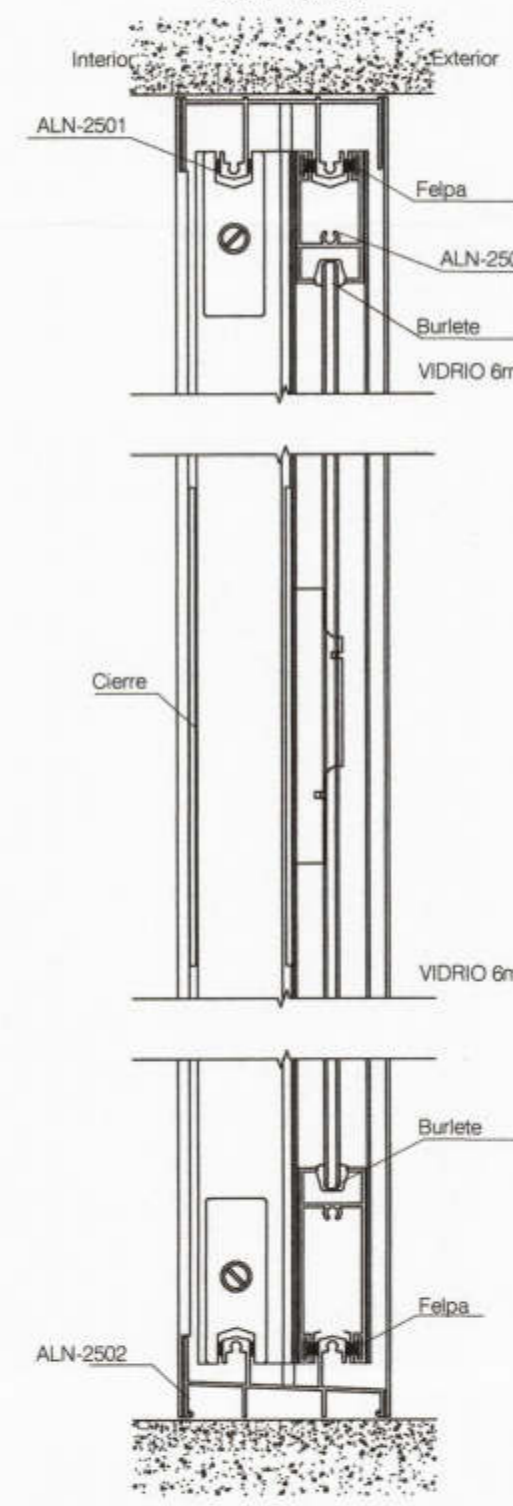

Detalle 07  
ESC: 1/10

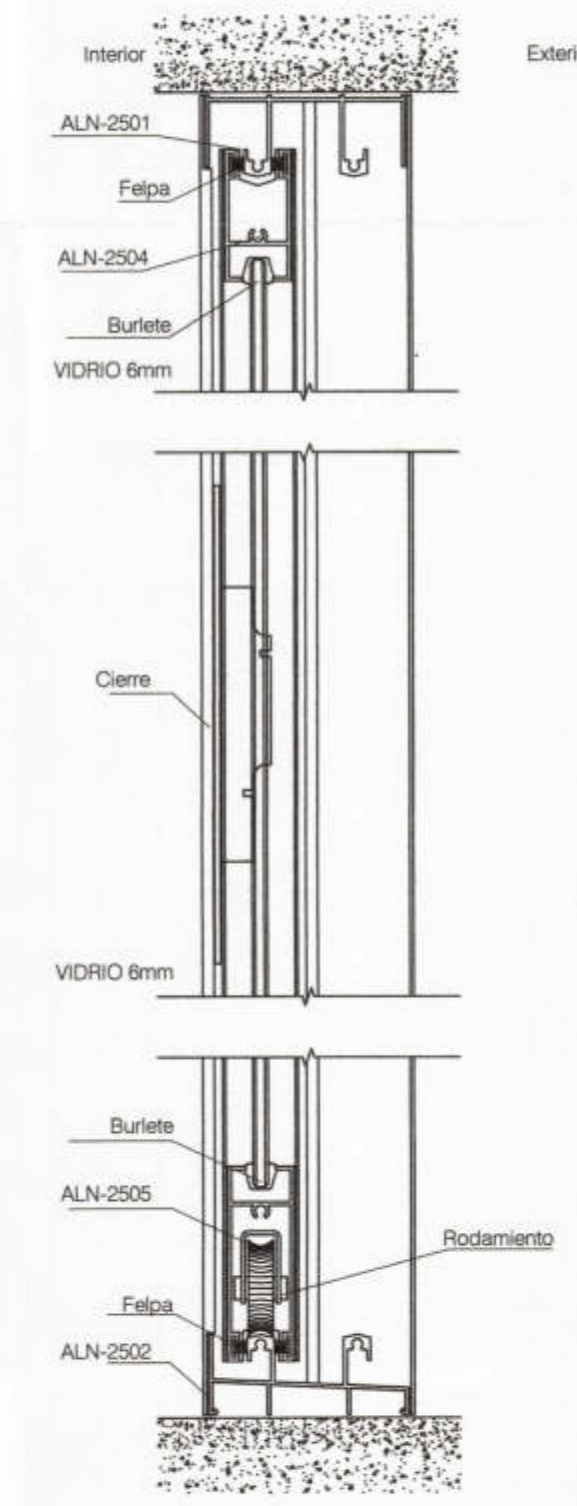

DET 09  
ESC: 1/5

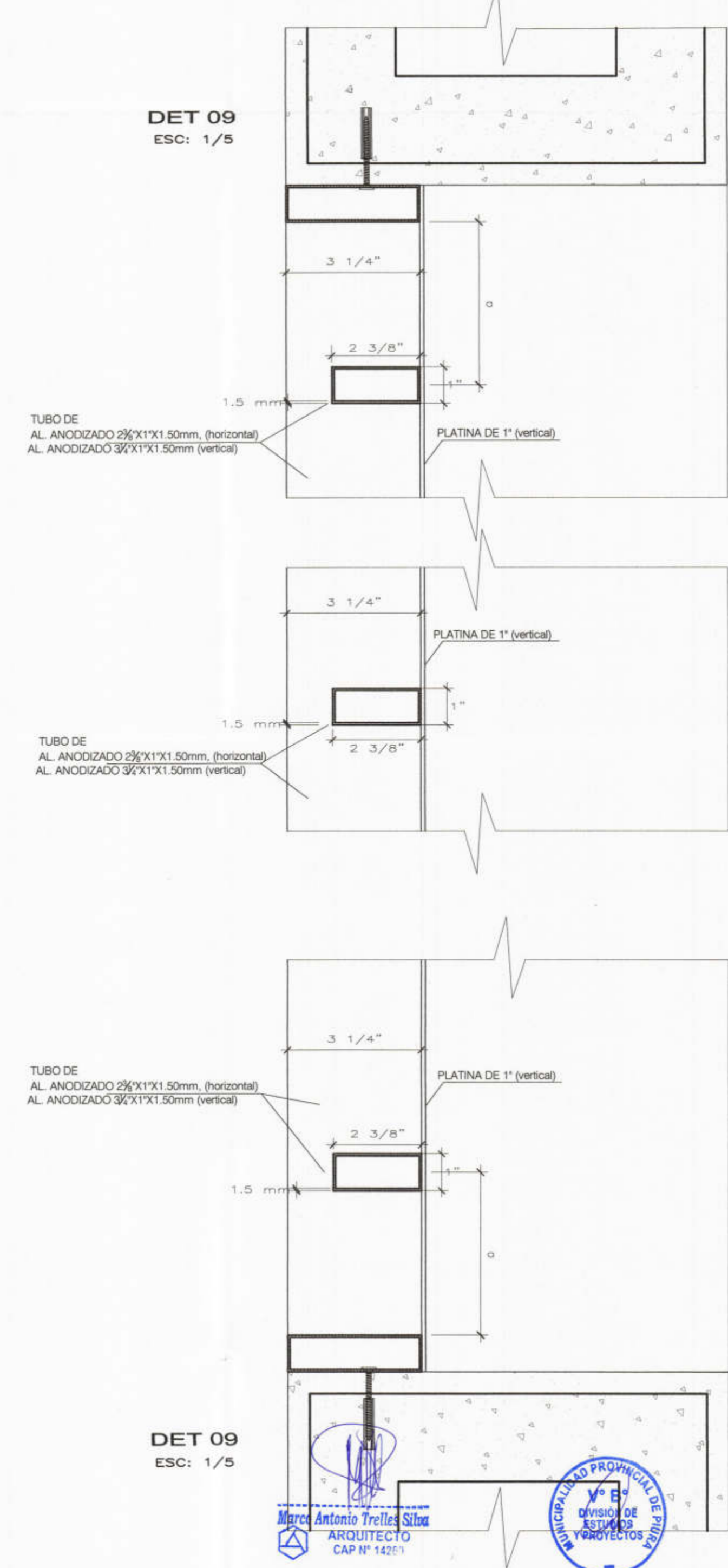

Detalle 01  
ESC: 1/10

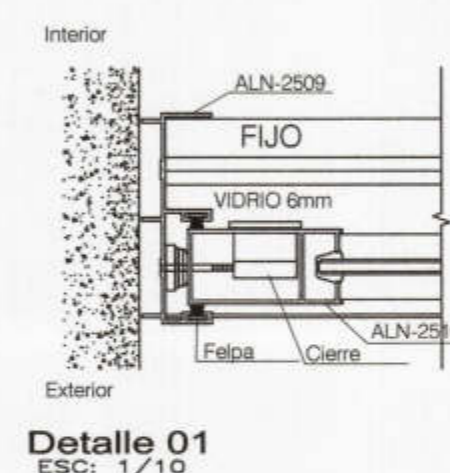

Detalle 02  
ESC: 1/10

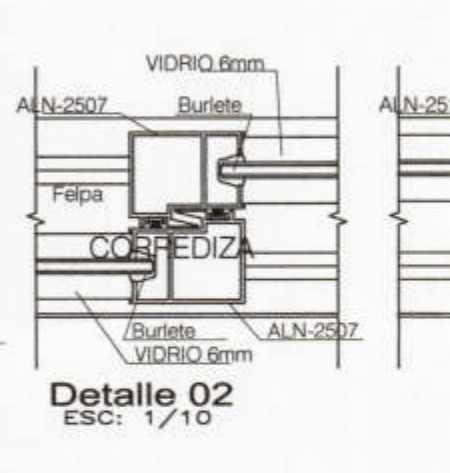

Detalle 03  
ESC: 1/10

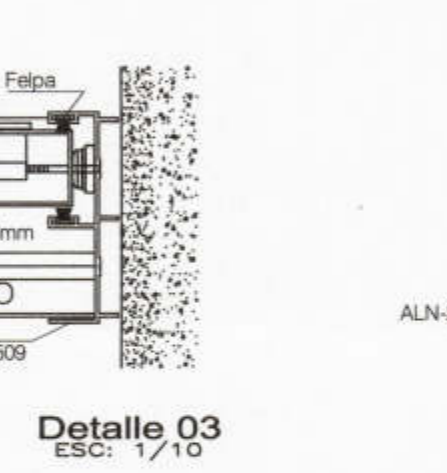

Detalle 04  
ESC: 1/10

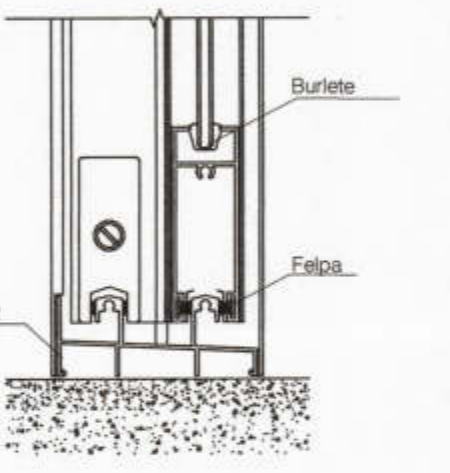

Detalle 06  
ESC: 1/10

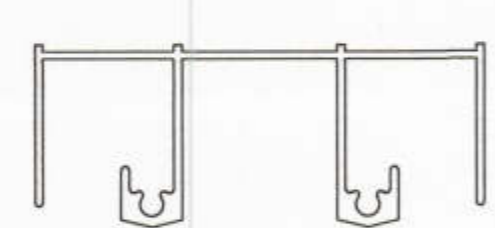
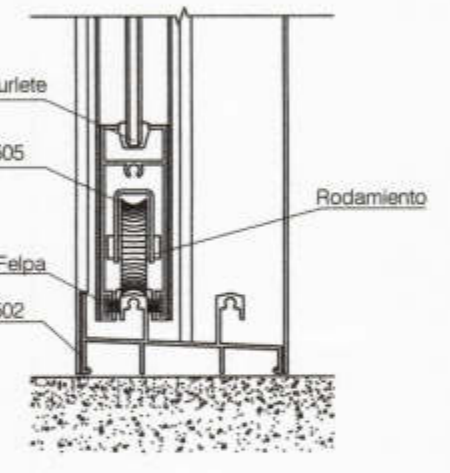

ALN-2501  
Riel superior

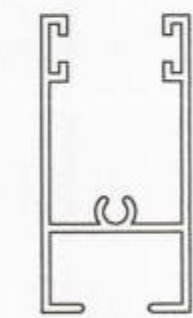

ALN-2504  
Cabezal

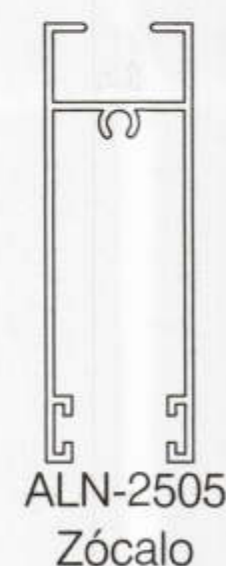

ALN-2505  
Zócalo

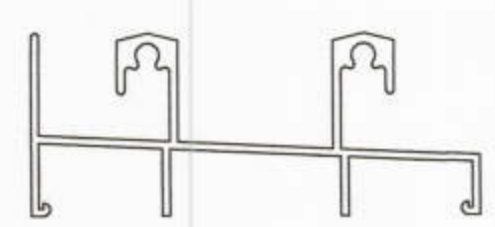

ALN-2502  
Riel inferior

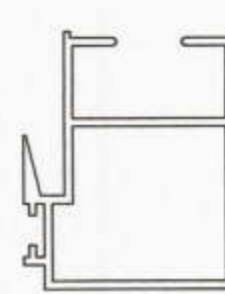

ALN-2507  
Traslapo

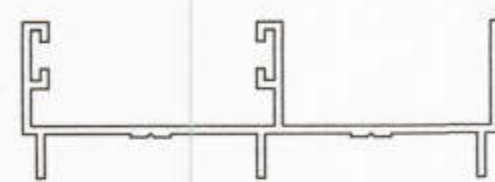

ALN-2509  
Jamba



Burlete Base  
Serie 25

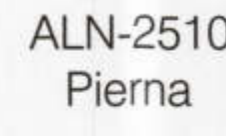

ALN-2510  
Pierna



Felpa F-15

PERFILES-BURLETES-FELPAS

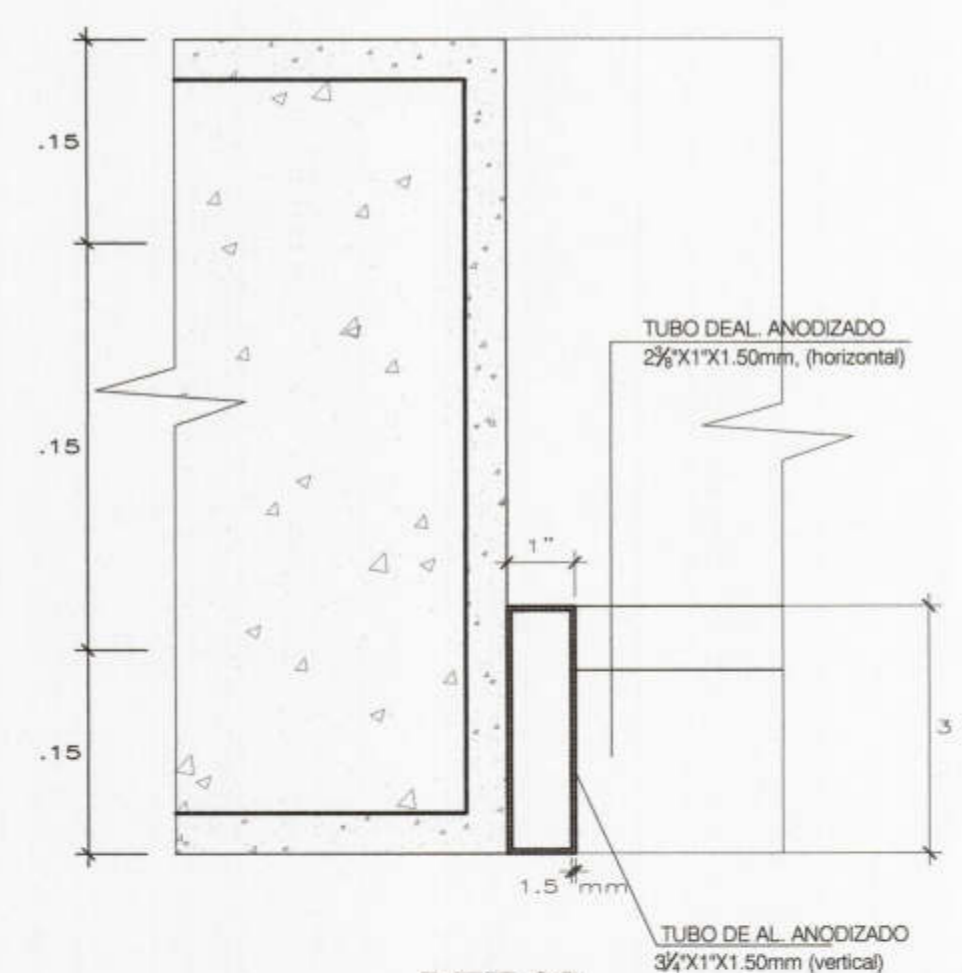

DET 08  
ESC: 1/5

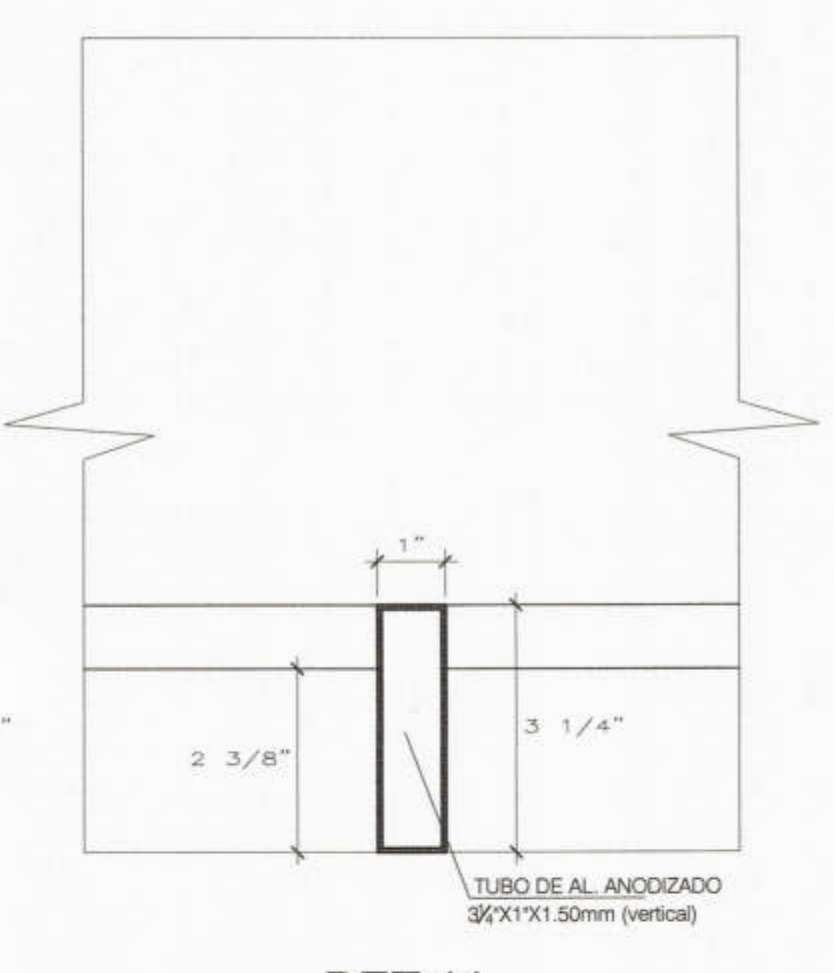

DET 11  
ESC: 1/5

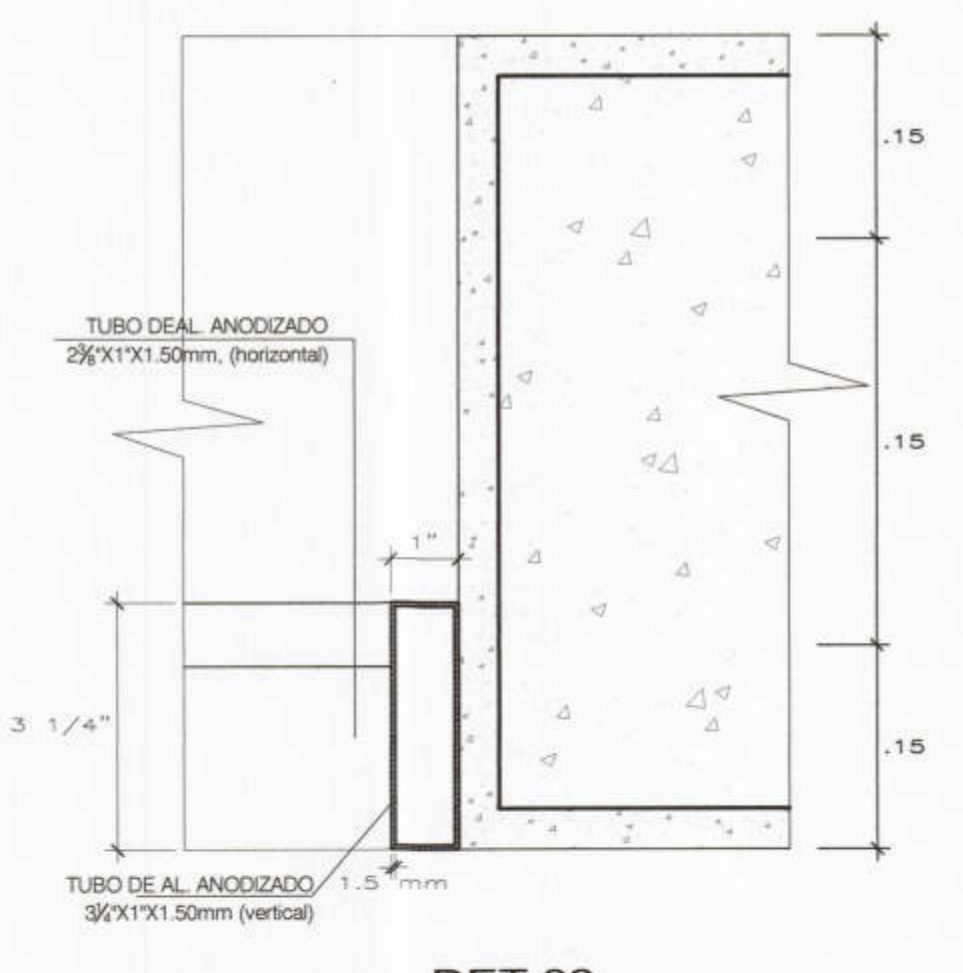

DET 08  
ESC: 1/5



PROYECTO :  
ELABORACIÓN DE 03 EXPEDIENTES TÉCNICOS DE INSTITUCIONES EDUCATIVAS, DISTRITO DE PIURA-PROVINCIA DE PIURA-PIURA

COMPONENTE 03:  
REHABILITACIÓN DEL LOCAL DE LA INSTITUCIÓN EDUCATIVA PARCEMON Saldarriaga-DISTRITO DE PIURA-PROVINCIA PIURA-REGIÓN GRAU

UBICACION:  
DEPARTAMENTO: PIURA  
PROVINCIA: PIURA  
DISTRITO: PIURA  
SECTOR: PACHITEA

CONSULTOR:  
CONSORCIO EL ALGARROBO

ESPECIALIDAD:  
ARQUITECTURA  
PLANO:  
CARPINTERIA DE MADERA  
DETALLES DE VENTANAS  
DIBUJO: XIN-VILL  
ESCALA: 1/25  
FECHA: SETIEMBRE 2019

EQUIPO DE DISEÑO:  
ARQ. MARCO TRELLES  
CAP 14260  
JEFE DE PROYECTO:  
ING. JOSÉ TALLEDO COVEÑAS  
REVISADO:  
APROBADO:

OBSERVACIONES  
FECHA

LAMINA:  
COMPONENTE 03  
ARQUITECTURA  
DA-19

CONSORCIO "EL ALGARROBO"  
Luis Stalling Zurita Chung  
REPRESENTANTE COMÚN  
DNI. 47902395  
Jose Franklin Talledo Coveñas  
INGENIERO CIVIL  
CIP. 22187

Marco Antonio Trelles Silva  
ARQUITECTO  
CAP N° 14261  
MUNICIPALIDAD PROVINCIAL DE PIURA  
DIRECCIÓN DE ESTUDIOS Y PROYECTOS